

FORM OF APPLICATION FOR MODIFICATION ORDER

WILDLIFE AND COUNTRYSIDE ACT 1981

Definitive Map and Statement - Staffordshire County Council

District of *STAFFORD*

Parish of *STONE*

To: Staffordshire County Council
PO Box 11
County Buildings
Stafford
ST16 2LH

I/We *M. Neay*
of *53. Tilke Barn Rd*
..... *Stafford*

hereby apply for an order under Section 53(2) of the Wildlife and Countryside Act 1981 modifying the definitive map and statement for the area by

~~* deleting the (footpath)(bridleway)(byway open to all traffic)~~
~~from~~ to

* *** adding the (footpath)(bridleway)(byway open to all traffic)
from *Grindley Bank/Grindley Ln* to *Path at Blythe bridge*

~~*(upgrading)(downgrading) to a (footpath)(bridleway)(byway open to all traffic) the (footpath)(bridleway)(byway open to all traffic)~~
~~from~~ to

~~*(varying)(adding to) the particulars relating to the (footpath)(bridleway) (byway open to all traffic) from~~ to
~~by providing that~~

and shown on the map accompanying this application.

I/We attach copies of the following documentary evidence (including statements of witnesses) in support of this application

*delete as appropriate.

- 1/ Deposited Railway plan Q/Ram/159 (1845).
- 2/ " " " Q/Ram/344 (1863).
- 3/ 0.5 bin to 1 mile 1879.

11/5/00. M. Reay

LK6 09G

Form 3

WILDLIFE AND COUNTRYSIDE ACT 1981

DEFINITIVE MAP AND STATEMENT - STAFFORDSHIRE COUNTY COUNCIL

CERTIFICATE OF SERVICE OF NOTICE OF APPLICATION
FOR MODIFICATION ORDER

To: Staffordshire County Council
of: PO Box 11,
County Buildings,
Martin Street,
Stafford, ST16 2LH

I/We *M. Reay*
of *53 Tithe Barn Rd*
..... *Stafford*

hereby certify that the requirements of paragraph 2 of Schedule 14 to the
Wildlife and Countryside Act 1981 have been complied with.

Dated *11/5/00* Signed *M. Reay*

Names and addresses of owners and occupiers of land on whom notice has been
served that an application for a Modification Order has been made:

Mr Johnson, Small Farm, Grindley, ST18 0LS.
Mr Flemming, Grindley Farm House, Grindley, ST18 0LR.
.....

Addition of path from Grindley Ln to F.P.29 Stone

Form 3

WILDLIFE AND COUNTRYSIDE ACT 1981

DEFINITIVE MAP AND STATEMENT - STAFFORDSHIRE COUNTY COUNCIL

CERTIFICATE OF SERVICE OF NOTICE OF APPLICATION
FOR MODIFICATION ORDER

To: Staffordshire County Council
of: PO Box 11,
County Buildings,
Martin Street,
Stafford, ST16 2LH

I/We *M. Reay*
of *53 The Barn Rd*
..... *Stafford*

hereby certify that the requirements of paragraph 2 of Schedule 14 to the Wildlife and Countryside Act 1981 have been complied with.

Dated *2/7/00* Signed *M. Reay*

Names and addresses of owners and occupiers of land on whom notice has been served that an application for a Modification Order has been made:

..... *Mr. Slaney, Powery Farm, Kingstone, Uttoxeter, Staffs.*
.....
.....

Q/Plan/159 East end of claimed route.

The claimed path is shown as 206 leading parallel to the highway no. 21.

Q/Plan/344 West end of claimed route.

The claimed path is shown as 78 leading parallel to the highway no. 77.

O.S. plan 1879.

This shows the claimed route running along the same course as shown on both deposited plans. It leaves the Grindley Ln and runs eastwards and connects onto another path near to the footbridge.

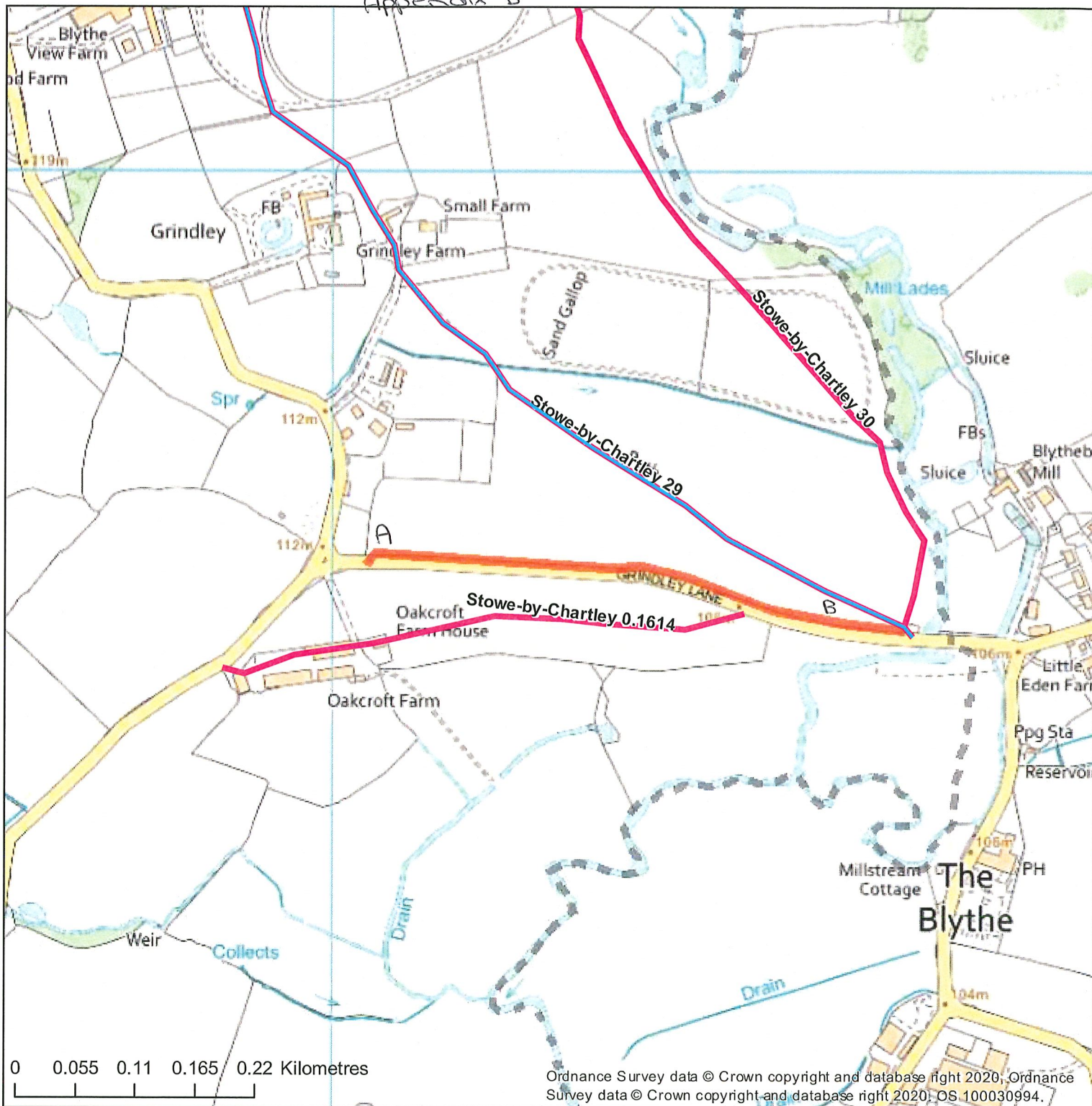

Public Rights of Way

- Footpath
- Section 53
- Parishes



Staffordshire County Council Map

Staffordshire County Council

Appendix C

- 20 b - Earl Ferrers - Public Foot road.
- 20 a - " " " "
- 20 c - " " - Foot road.
- 21 - Surveyors at Highways - Parish Road.

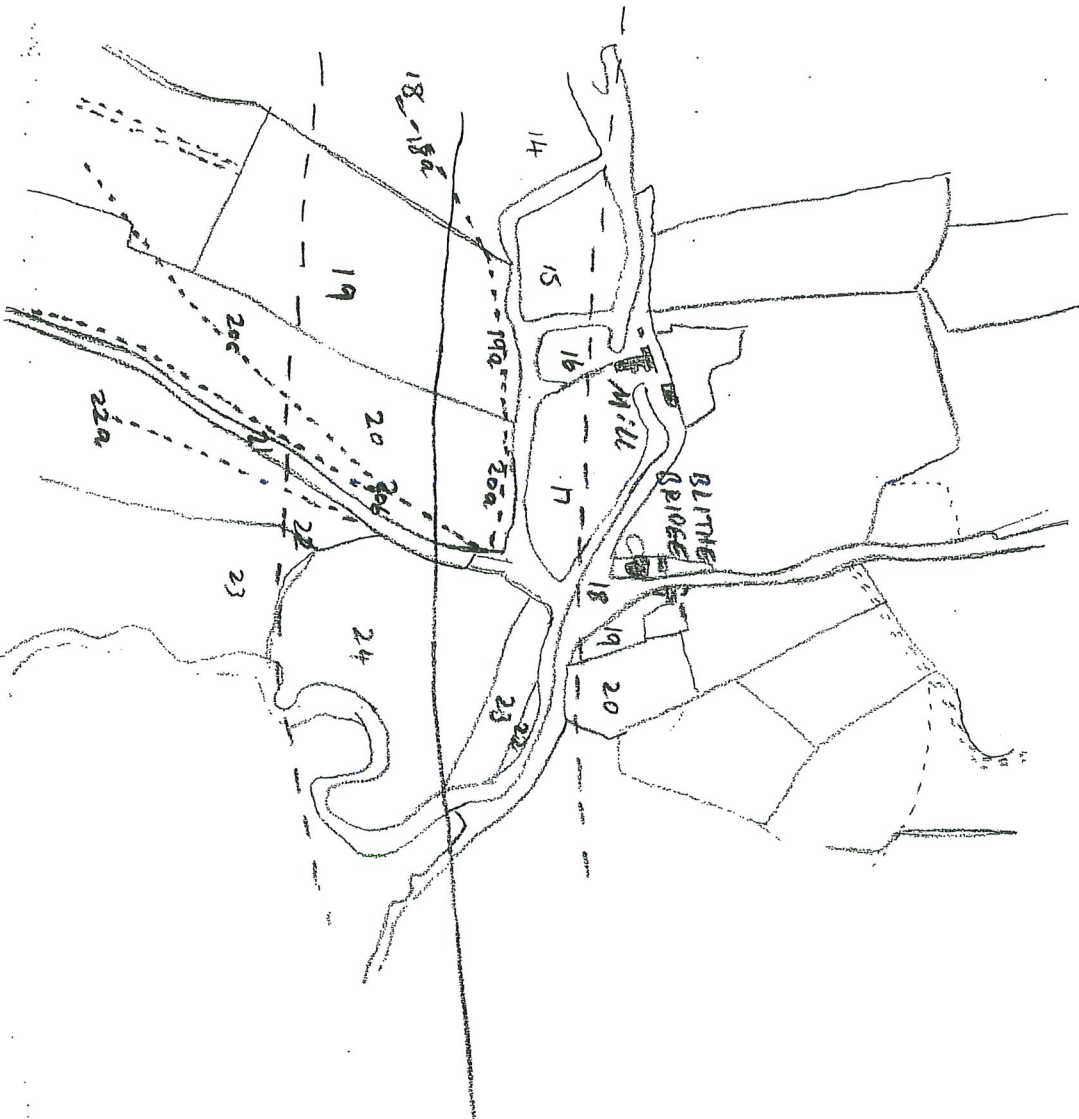

10. 1. FORMER MANORIAL AND HIGHFIELD OR CHURCH AND BLITHES BRIDGE SANCTION RAILWAY

Appendix D

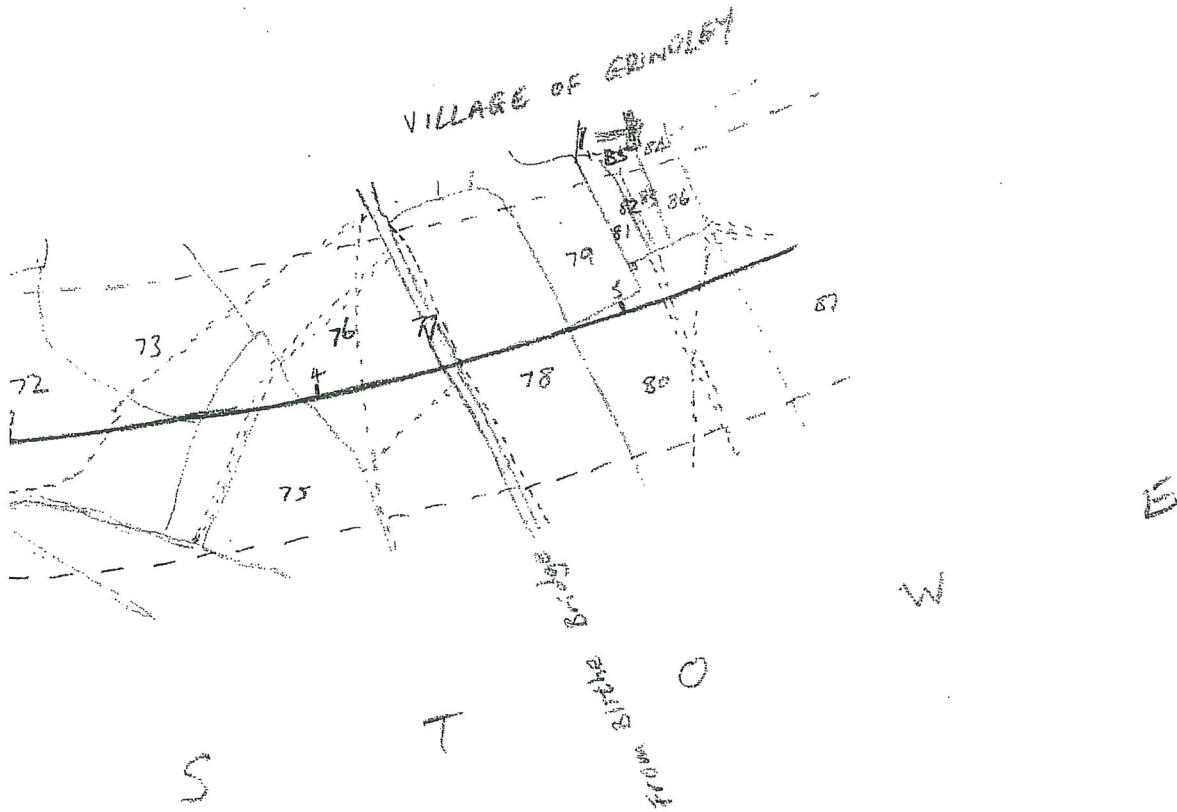

PARISH OF STOWE.

77 - PUBLIC ROAD - SURVEYORS OF HIGHWAYS.

78 - FIELD + PUBLIC FOOTPATH - EARL FERRERS
AND SURVEYORS OF HIGHWAYS.

Q/RUN/344 (1863)

THE NORTH + SOUTH STAFFS JUNCTION
RAILWAY AND BRANCHES.

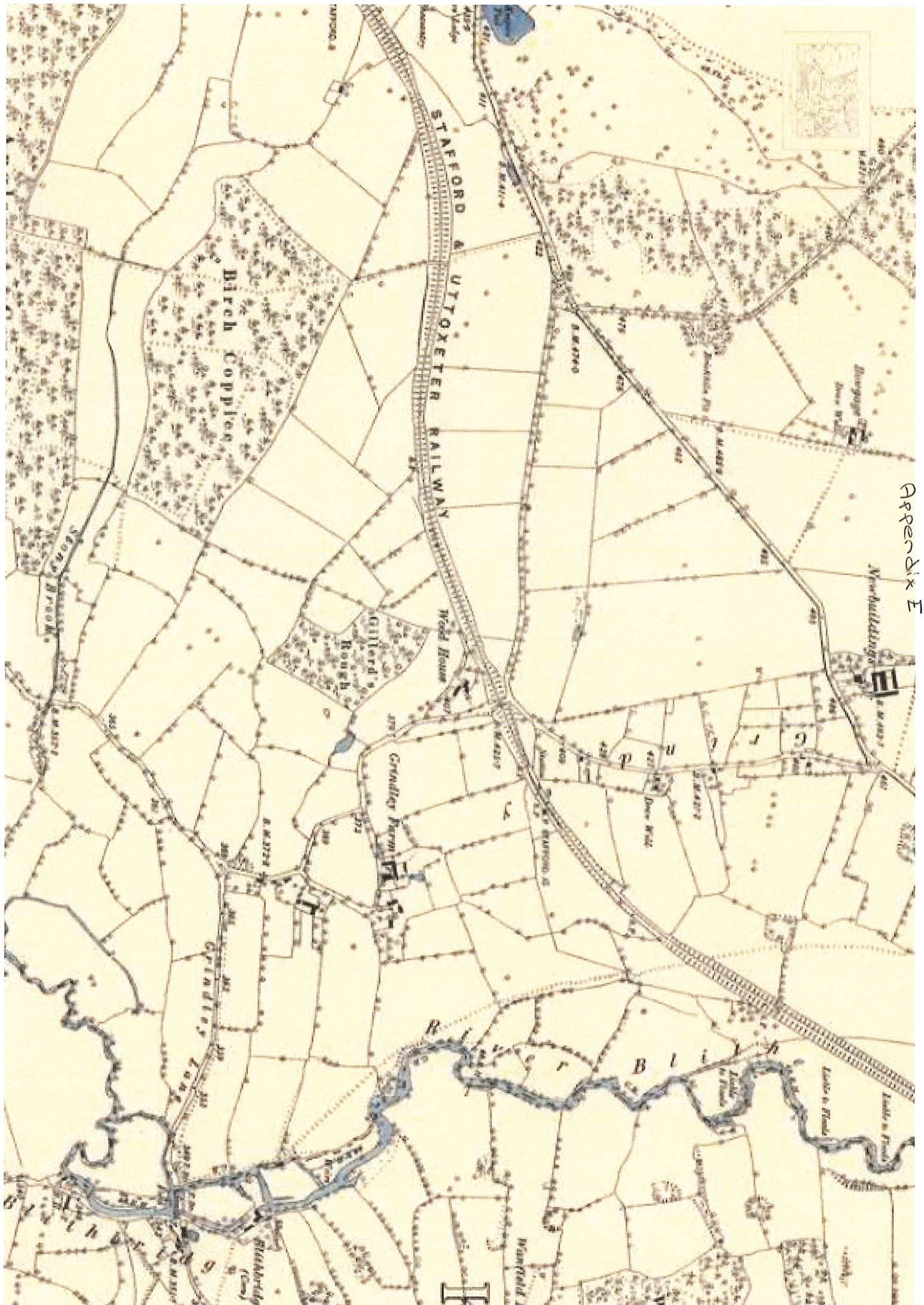

Appendix E



Stafford
BOROUGH COUNCIL

John Gregory Esq
Director of Central Services
Staffordshire County Council
P O Box 11
County Buildings
Martin Street
Stafford ST16 2LH

Contact Mr G Parker
Direct Dial 01785 619210
Fax 01785 619119
E-Mail
Our Ref DS5/1/GP/GVK
Your Ref 4/MTM/LK609G
Date 18 August 2000

Dear Sir

APPLICATION FOR THE ADDITION OF A FOOTPATH FROM GRINDLEY LANE TO FOOTPATH NO 29 STOWE PARISH TO THE DEFINITIVE MAP

I refer to your letter dated 12 June 2000.

I can confirm that the Borough Council has no comments to make on this application.

Yours faithfully

A R Welch LLB (Hons) Solicitor
Head of Law and Administration

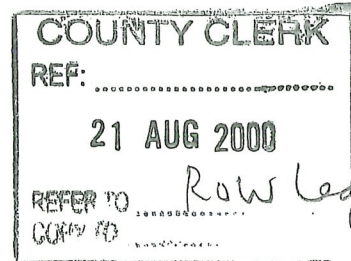
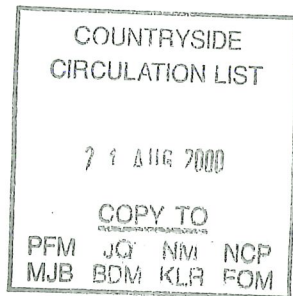

Central Services Department



INVESTOR IN PEOPLE

Stafford Borough Council, Civic Centre, Riverside, Stafford ST16 3AQ
Switchboard 01785 619000 Web Site www.staffordbc.gov.uk

The Ramblers' Association
Working for walkers

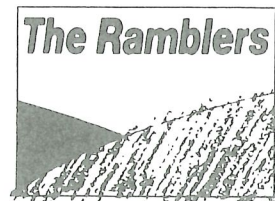

Staffordshire Area

34, Greenfield Road,
STAFFORD
ST17 0PU
19 July 2000

Your Ref: 4/MTM/LK609G
My Ref ctylegal.wps

John Gregory Esq.,
Director of Central Services,
Staffordshire County Council,
P.O Box 11,
Martin Street,
STAFFORD
ST16 2LH

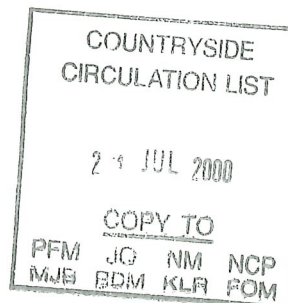

For the attention of Michael Murphy

Dear Mr Murphy,

Wildlife and Countryside Act 1981
Alleged footpath leading from Grindley Lane to FP 29 Stowe Parish

Thank you for your letter dated 12th June 2000.

Thank you for consulting us on this application to add a path to the Definitive Map. This application submitted by Mr Martin Reay has the full support of our Association.

We look forward to the inclusion of this path on the Definitive Map.

Yours sincerely,

T David Palmer

Local Footpath Secretary for the parish of Stowe in Stafford Borough

